



EGNATIA ODOS S.A.

SECTION POLYMYLOS - LEYKOPETRA / BRIDGE I8 AT CHAINAGE 24.0+943.04

PROJECT BUDGET: 8.522.380 €
CONSTRUCTION: JOINT VENTURE ATTIKAT S.A. - K.I. SARANTOPOULOS S.A.
J&P (HELLAS) S.A. - TEGK S.A.
STRUCTURAL DESIGN: KANON CONSULTING (2001)

This particular bridge consists of two independent branches, one for each direction of traffic. The total deck width measured 13.60m: 11.0m for the road surface and 2.60m for the two sidewalks. The two bridge branches had a distance between them of approximately 1.10m. In sum, the total length of the right branch of the bridge was 204.50m (53.59+97.31+53.61), while that of the left branch was 207.50m (54.41+98.69+54.39).

The deck was integrally connected to the middle piers M1 and M2 and supported by pot bearings located at the abutments. The deck also had a box cross-section and a variable height. With regard to the middle span M1-M2, the height ranged from 6.25m to 3.20m, while the height ranged between 6.25m to 2.60 for the remaining spans A1-M1 and M2-A2. In addition, the deck's construction was based on the balanced cantilever method.

The middle piers were approximately 30.0m high, with a cross-section comprised of a pair of parallel wall sections measuring 7.00x1.20m. The foundation of the middle piers for both branches was created by the construction of a unified concrete caisson measuring at 9.0x23.7m and 11.0m deep.

A common foundation for both branches, 10.0x28.8m was constructed for abutment A1 without any joining between the two branches. Due to the poor quality of the soil, we founded abutment A2 with 1.20m diameter piles measuring 14.0m long.

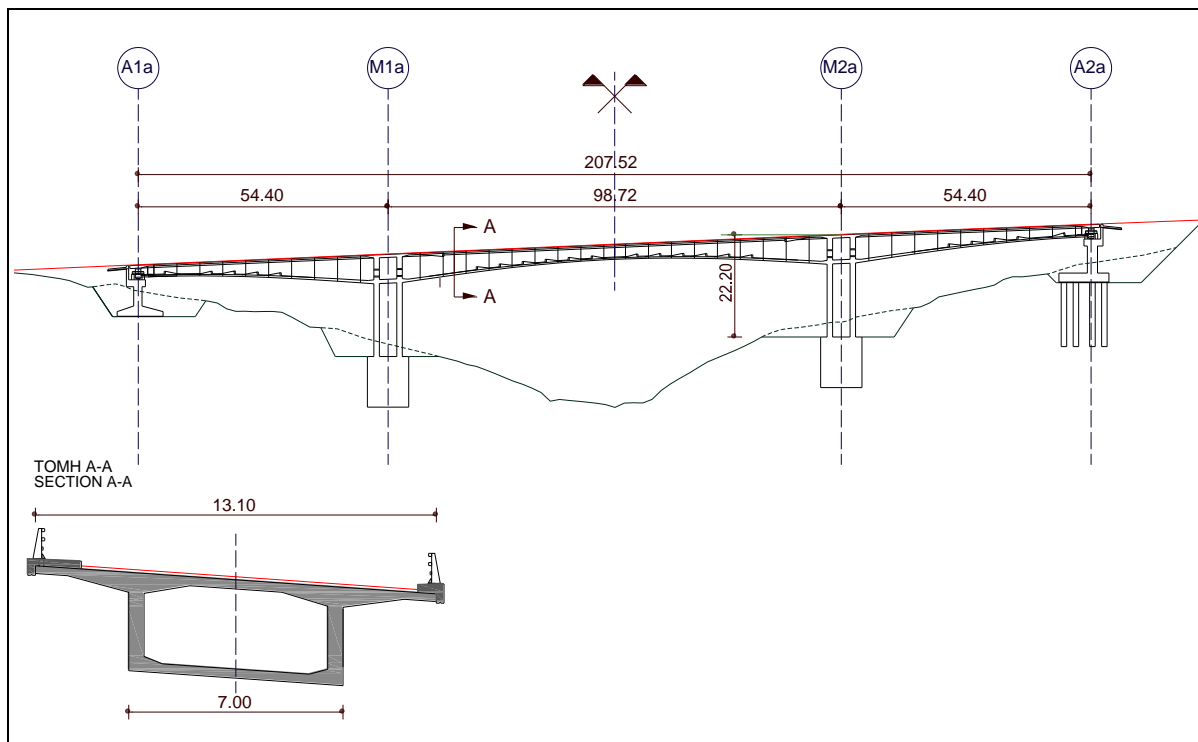

Egnatia Odos: Longitudinal section of the left branch and cross section of the Bridge I8